

PT

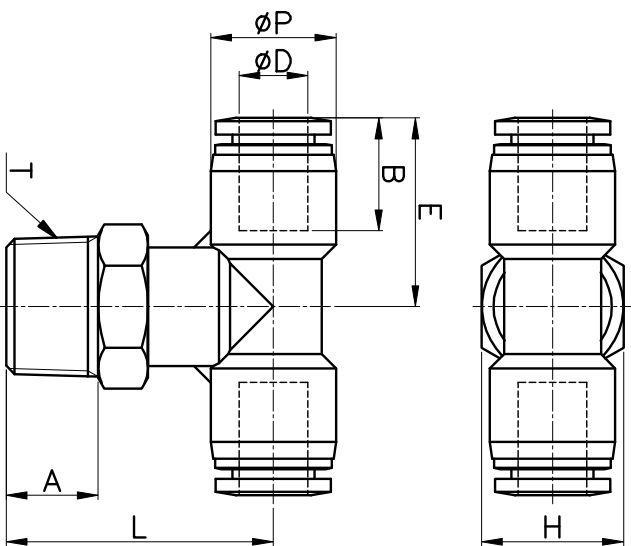

MODEL	ØD	ØP	T	L	E	A	B	H ^H (Hex)	ORIFICE	WEIGHT (g)	BOX(EA)
PT 04-M5	4	10.5	M5*0.8p	20.5	18.5	4.0	14.8	10	2.5	10.0	100
PT 04-M6			M6*1.0p	20.6		4.1		10		10.0	
PT 04-01			R 1/8	24.5		8.0		10		11.0	100
PT 04-02			R 1/4	26.5		10.0		14	3.0	17.0	100
PT 04-03			R 3/8	27.5		11.0		17		26.0	50
PT 06-M5			M5*0.8p	22.5		4.0		12		15.0	50
PT 06-M6	6	12.5	M6*1.0p	22.6	20.3	4.1	16.4	12	3.0	15.0	50
PT 06-01			R 1/8	26.5		8.0		12		17.0	50
PT 06-02			R 1/4	29.5		10.0		14		21.0	50
PT 06-03			R 3/8	30.5		11.0		17	4.0	29.0	50
PT 06-04			R 1/2	33.5		14.0		21		56.0	25
PT 08-01			R 1/8	28.0		8.0		14		21.0	50
PT 08-02	8	15.0	R 1/4	31.0	22.6	10.0	18.3	14	6.0	24.0	50
PT 08-03			R 3/8	32.0		11.0		17		31.0	50
PT 08-04			R 1/2	35.0		14.0		21		54.0	25
PT 10-01	10	17.5	R 1/8	28.5	25.2	8.0	20.2	17	6.0	33.0	25
PT 10-02			R 1/4	31.5		10.0		17		35.0	25
PT 10-03			R 3/8	32.5		11.0		17		36.0	25
PT 10-04			R 1/2	35.5		14.0		21	8.0	60.0	25
PT 12-01			R 1/8	32.4		8.0		19		50.0	25
PT 12-02			R 1/4	34.4		10.0		19		47.0	25
PT 12-03	12	20.5	R 3/8	35.4	28.7	11.0	22.9	19	9.0	50.0	25
PT 12-04			R 1/2	38.4		14.0		21		60.0	20
PT 16-03			R 3/8	42.8		11.0		24		86.0	12
PT 16-04	16	25.5	R 1/2	45.8	32.8	14.0	24.1	24	13.0	94.0	12